

DRAWING INDEX		MTCAP SUBMISSION 7/26/24
DRAWINGS:	NUMBER OF SHEETS	
ARCHITECTURAL:		
A-0.00	TITLE SHEET	•
A-1.00	SITE PLAN / FIRE AND LIFE SAFETY PLANS	•
STRUCTURAL:		
S0.1	GENERAL NOTES	•
S0.2	MATERIAL TESTING AND CONDITION ASSESSMENT SUMMARY	•
S.1	KITCHEN BUILDING BASEMENT	•
S.2	KITCHEN BUILDING FOUNDATION	•
S.3	KITCHEN BUILDING FLOOR PLAN	•
S.4	KITCHEN BUILDING ROOF PLAN	•
S.5	CONDITION ASSESSMENT DETAILS	•

SCOPE OF WORK

WORK SHALL INCLUDE:

1. VERIFICATION OF EXISTING CONDITIONS OR CONDITION ASSESSMENT TO SATISFY MTCAP PER STRUCTURAL DRAWINGS.
2. REPAIR THE AREAS ALTERED FOR EXTRACTING SAMPLES OR CONDITION ASSESSMENT BACK TO ORIGINAL STATE AS INDICATED ON THESE DOCUMENTS AND MTCAP PER STRUCTURAL DRAWINGS.
3. PROVIDE MEANS AND METHOD DURING CONDITION ASSESSMENTS TO SATISFY THESE DOCUMENTS AND MTCAP PER STRUCTURAL DRAWINGS.

BUILDING INFORMATION

OSHPD FACILITY ID : 11417
 OSHPD BUILDING NUMBER : 00731
 OSHPD PROJECT NUMBER :
 ZONING : EXISTING (NO CHANGE)
 APPLICATION / JURISDICTION : OSHPD 1
 CONSTRUCTION DATE : CIRCA 1902
 CONSTRUCTION : TYPE 5 OF EXISTING BUILDING
 OCCUPANCY SEPARATIONS : EXISTING - NO CHANGE
 AUTOMATIC FIRE SPRINKLER : NO
 BUILDING HEIGHT : +/- 18'-9" ABOVE GRADE
 TOTAL SQUARE FOOTAGE : 6,039 SF
 LICENSED BED SUMMARY : EXISTING - NO CHANGE
 ALLOWABLE FLOOR AREA : EXISTING - NO CHANGE
 PARKING SUMMARY : EXISTING - NO CHANGE
 FIRE LIFE SAFETY PLANS : SEE SHEET A1.00

BUILDING GENERAL NOTES

ARCHITECTURAL NOTES:

1. ALL DEPARTMENTS WILL REMAIN OPERATIONAL DURING THE MATERIAL TESTING. CONSTRUCTION BARRIERS WILL BE INSTALLED TO ISOLATE WORK AREAS.
2. EXISTING CIRCULATION THROUGHOUT THE BUILDING WILL NOT BE COMPROMISED WHILE TESTING IS UNDERWAY.
3. ALL ESSENTIAL SERVICES AND SUPPORT ARRANGEMENT(S) SHALL REMAIN FUNCTIONING WHILE TESTING IS IN PROGRESS.
4. THE HOSPITAL INTENDS TO MAINTAIN PATIENT SERVICES AND HOSPITAL FUNCTIONS THROUGHOUT TESTING.
5. IF THE SPACE(S) ARE TO REMAIN OCCUPIED AND THE USE OF A "TEMPORARY BARRIER" IS INTENDED TO BE USED DURING CONSTRUCTION TO SEPARATE THE CONSTRUCTION AREA FROM OTHER OCCUPIED PORTIONS OF THE BUILDING, USE HUSKY POLY-AMERICA 6MIL FIRE RETARDANT POLYETHYLENE FILM CONSTRUCTION SHEETING WITH FLAME SPREAD INDEX OF 15 (ASTM E84) FOLLOWING 2022 CFC, SECTION 3305.9.

FIRE & LIFE SAFETY NOTES

FIRE RATED ASSEMBLIES, INCLUDING FIREPROOFING, DAMAGED DURING TESTING MUST BE RESTORED TO THEIR ORIGINAL CONDITION. HCAI FIELD FIRE AND LIFE SAFETY OFFICER MUST REVIEW DETAILS AND REQUIREMENTS FOR RESTORATION OF ALL FIRE RATED ASSEMBLIES.

FIRE-RESISTIVE ASSEMBLIES, FIRE-RESISTIVE CONSTRUCTION, AND THE MEANS OF EGRESS MUST BE MAINTAINED IN ACCORDANCE WITH CHAPTER 14 OF THE CALIFORNIA FIRE CODE. WHEN IT IS NOT POSSIBLE TO MAINTAIN FIRE-RESISTIVE ASSEMBLIES, FIRE-RESISTIVE CONSTRUCTION AND/OR MEANS OF EGRESS, TEMPORARY CONSTRUCTION BARRIERS AND/OR A FIRE WATCH MUST BE PROVIDED IN ACCORDANCE WITH OFFICE OF CALIFORNIA DEPARTMENT OF HEALTHCARE ACCESS AND INFORMATION CODE APPLICATION NOTICE (CAN) 9-1401 AND POLICY INTENT NOTICE (PIN) 14.

ALL OCCUPIABLE FLOORS SHALL BE PROVIDED WITH FIRE SPRINKLER PROTECTION PRIOR TO COMPLETION OF CONSTRUCTION AND HCAI CERTIFIED OF OCCUPANCY, IN ACCORDANCE WITH CBC 903.2.6

APPLICABLE CODE

2022 CALIFORNIA ADMINISTRATIVE CODE (CAC)
 PART 1, TITLE 24, CALIFORNIA CODE OF REGULATIONS (CCR)

2022 CALIFORNIA BUILDING CODE (CBC)
 PART 2, TITLE 24, CCR (2021 IBC)

2022 CALIFORNIA ELECTRICAL CODE (CEC)
 PART 3, TITLE 24, CCR (2020 NEC)

2022 CALIFORNIA MECHANICAL CODE (CMC)
 PART 4, TITLE 24, CCR (2021 UMC)

2022 CALIFORNIA PLUMBING CODE (CPC)
 PART 5, TITLE 24, CCR (2021 UPC)

2022 CALIFORNIA FIRE CODE (CFC)
 PART 9, TITLE 24, CCR (2021 IFC)

2022 CALIFORNIA ENERGY CODE

2022 CALIFORNIA REFERENCED STANDARD

TITLE 19 C.C.R., PUBLIC SAFETY, SFM REGULATIONS

AMERICAN WITH DISABILITIES ACT (ADA) TITLE II
 ADA STANDARDS FOR ACCESSIBLE DESIGN (APPENDIX A OF 28 CFR PART 36)

PROJECT DIRECTORY

OWNER/APPLICANT:
 BARLOW RESPIRATORY HOSPITAL
 2000 STADIUM WAY,
 LOS ANGELES, CA 90026
 TEL: 213-202-6845

STRUCTURAL ENGINEER:
 WALTER P MOORE
 633 WEST 5TH STREET, SUITE 7200
 LOS ANGELES, CA 90017
 310-254-1800

ARCHITECT:
 ZAKIAN WOO ARCHITECTS
 9018 LINDBLADE STREET
 CULVER CITY, CA 90232
 TEL: 310-202-9900
 FAX: 310-841-6228

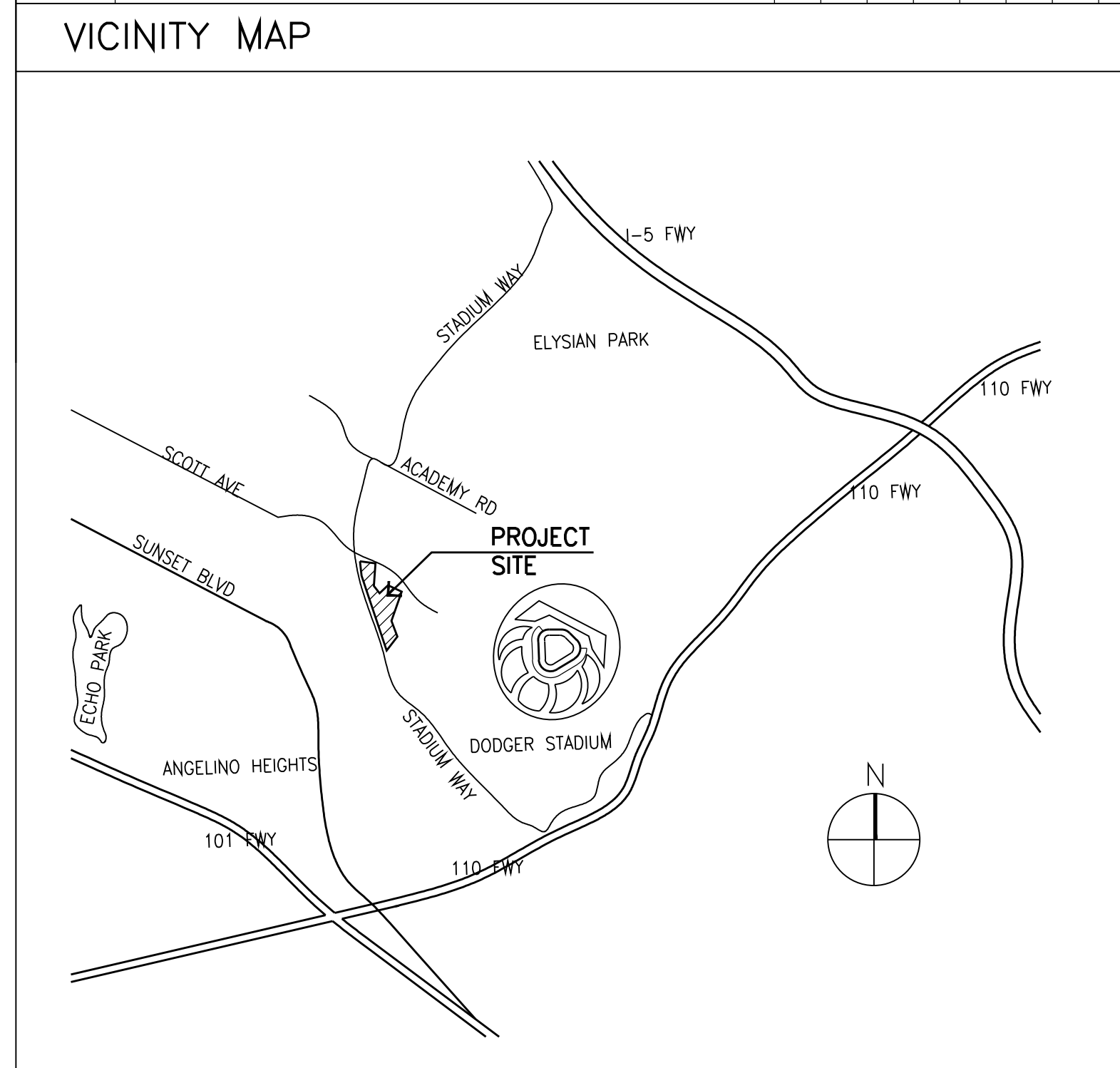

BARLOW RESPIRATORY HOSPITAL

2000 STADIUM WAY, LOS ANGELES, CA 90026

MATERIAL TESTING & CONDITIONS ASSESSMENT PROGRAM (MTCAP)

1902 BUILDING - DINING/KITCHEN BUILDING & ADDITIONS - BLD-00731

FACILITY NUMBER 11417



Barlow Respiratory HOSPITAL
 2000 STADIUM WAY
 LOS ANGELES, CA 90026

Z W Architects
 Zakian Woo Architects
 9018 Lindblade Street
 Culver City, CA
 90232
 Tel: 310-202-9900
 Fax: 310-841-6228

OWNER
 BARLOW RESPIRATORY HOSPITAL
 2000 Stadium Way
 Los Angeles, CA 90026
 (213) 202-6845

ARCHITECT
 Zakian Woo Architects
 9018 Lindblade Street
 Culver City, CA 90232
 (310) 202-9900
 (310) 841-6228 (fax)

STRUCTURAL ENGINEERS & MEP ENGINEERS
 Walter P Moore
 707 Wilshire Boulevard, Suite 2100
 Los Angeles, CA 90017
 (213) 694-4775
 (925) 549-7313 (cel)



Agency Approval Stamp

REVIEWED IN ACCORDANCE WITH THE REGULATIONS OF THE CALIFORNIA BOARD OF ARCHITECTS
APPROVED
 Office of Healthcare Planning & Development
 10/28/2024, 8:18:49 AM
 SQA115-19-00
 Lynn Wang

FACILITY ID No.
 11417

All ideas, designs, arrangements and notes indicated or requested by this drawing are owned by and the property of Zakian Woo Architects and shall not be reproduced or used for any other project without the express written permission of Zakian Woo Architects. Written dimensions on these drawings shall have precedence over verbal dimensions. Contractors shall verify and be responsible for all dimensions and conditions on the job, and this office must be notified of any variations from the dimensions and conditions shown by these drawings.

NO.	ISSUE	DATE
1	BACKCHECK 1	10/21/24
	OSHPD SUBMITTAL	08/03/24

Revisions

Name & Location:
 BARLOW RESPIRATORY HOSPITAL
 2000 STADIUM WAY
 LOS ANGELES, CA 90026

Project Title:
 MATERIAL TESTING & CONDITIONS ASSESSMENT PROGRAM (MTCAP) FOR DINING KITCHEN BUILDING AND ADDITIONS (1902 Bldg) BLD 00731

Key Plan:

Project No:
 Issued For: MTCAP
 Drawing:

TITLE SHEET

Scale: AS NOTED ON DRAWINGS

Date: AUGUST 3, 2024

Drawing No:
 A-0.00

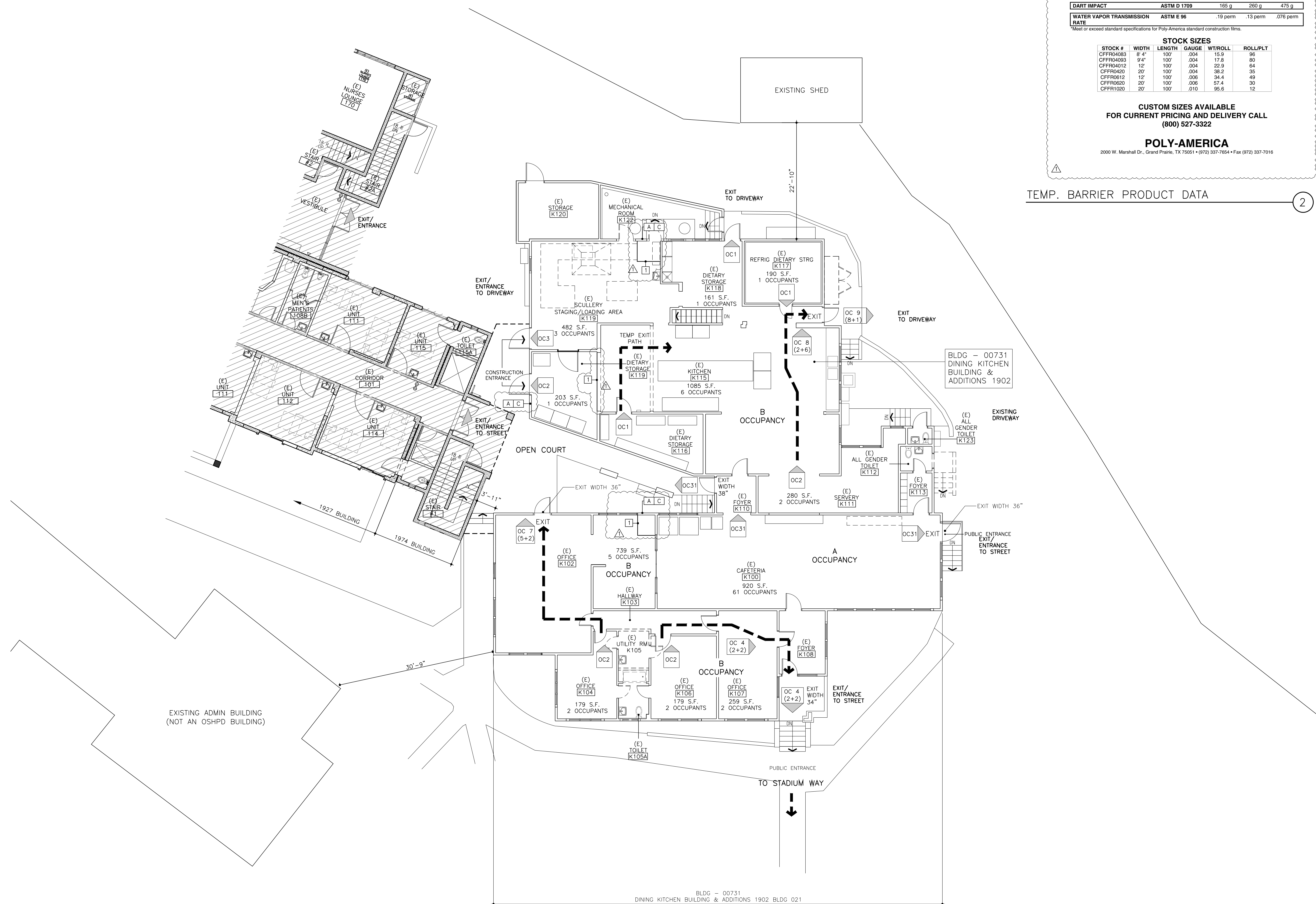

FLAME RETARDANT POLYETHYLENE FILM

IDEALLY SUITED FOR ANY APPLICATION REQUIRING A PROTECTIVE COVERING WITH FLAME RETARDANT CHARACTERISTICS

TEST RESULTS*

BURNING CHARACTERISTICS	4 MIL	6 MIL	10 MIL
FLAME SPREAD INDEX	10	15	15
SMOKE DEVELOPMENT	70	75	85
CHAR: 1050 MM MAXIMUM INDIVIDUAL	PASS		
DRIIP BURN: 2 SEC. MAXIMUM INDIVIDUAL	PASS		
AFTER FLAME: 2 SEC. MAXIMUM INDIVIDUAL	PASS		

TENSILE STRENGTH	ASTM D 882	1700 psi	1700 psi	1700 psi
MD		1200 psi	1200 psi	1200 psi
TD				

ELONGATION	ASTM D 882	225%	225%	225%
MD		350%	350%	350%
TD				

DART IMPACT	ASTM D 1709	165 g	260 g	475 g
MD				
TD				

WATER VAPOR TRANSMISSION RATE	ASTM E 96	.19 perm	.13 perm	.076 perm
MD				
TD				

*Meet or exceed standard specifications for Poly-America standard construction films.

STOCK SIZES

STOCK #	WIDTH	LENGTH	GAUGE	WT/ROLL	ROLL/PLT
CFFR04083	8' 4"	100'	.004	15.9	96
CFFR04093	9' 4"	100'	.004	17.8	80
CFFR04012	12'	100'	.004	22.9	64
CFFR0420	20'	100'	.004	38.2	35
CFFR0312	12'	100'	.006	34.4	49
CFFR0620	20'	100'	.006	57.4	30
CFFR1020	20'	100'	.010	95.6	12

CUSTOM SIZES AVAILABLE FOR CURRENT PRICING AND DELIVERY CALL (800) 527-3322

POLY-AMERICA
2000 W. Marshall Dr., Grand Prairie, TX 75051 • (972) 537-7654 • Fax (972) 337-7016

TEMP. BARRIER PRODUCT DATA ②

GENERAL NOTES

- NO (E) FIRE RESISTIVE CONSTRUCTION IN 1902 BUILDING.
- ### TESTING AND REPAIR NOTES
- VERIFICATION FOR CA-4C/1-2 ACCESS IS PREDOMINANTLY FROM CRAWL SPACE. IF ACCESS FROM FLOOR LEVEL IS REQUIRED:
 - PARTIAL REMOVE OF BASEBOARD AND PLASTER TO EXPOSE WALL BOTTOM PLATE. PEEL BACK FLOORING AS REQUIRED.
 - REPAIR PLASTER TO MATCH (E). REPLACE OR REPAIR (E) BASEBOARD TO MATCH (E). REPAIR OR REPLACE FLOORING IF DAMAGED.
 - VERIFICATION FOR CA-2C/3 ACCESS IS PREDOMINANTLY FROM ROOF. IF ACCESS FROM CEILING IS REQUIRED:
 - PARTIALLY REMOVE PLASTER FROM (E) PARTITION / (E) CEILING AS REQUIRED.
 - REPAIR OR REPLACE PLASTER CEILING AND PARTITION TO MATCH (E).
 - PAINT TO MATCH (E).
 - VERIFICATION FOR CA-2C/1-2 ACCESS IS PREDOMINANTLY FROM ATTIC. IF ACCESS FROM BELOW IS REQUIRED:
 - CUT OPENING IN PLASTER CEILING OR PARTITION BETWEEN STUDS AS REQUIRED. DO NOT CUT INTO COVED PARTS OF CEILING.
 - REPAIR OR REPLACE PLASTER CEILING AND PARTITION TO MATCH (E).
 - PAINT TO MATCH (E).
 - VERIFICATION FOR CA-4C/3 ACCESS IS PREDOMINANTLY FROM CRAWL SPACE. IF ACCESS FROM FLOOR LEVEL IS REQUIRED:
 - PARTIAL REMOVE OF BASEBOARD AND PLASTER TO EXPOSE WALL BOTTOM PLATE. PEEL BACK FLOORING AS REQUIRED.
 - REPAIR PLASTER TO MATCH (E). REPLACE OR REPAIR (E) BASEBOARD TO MATCH (E). REPAIR OR REPLACE FLOORING IF DAMAGED.

PROTECTIVE CONSTRUCTION BARRIER KEYNOTES

- FOR CONSTRUCTION BARRIER, USE HUSKY POLY-AMERICA FLAME RETARDANT POLYETHYLENE FILM CONSTRUCTION SHEETING 6MIL WITH FLAME SPREAD INDEX OF 15 (ASTM E84).

Barlow Respiratory Hospital
2000 STADIUM WAY
LOS ANGELES, CA 90026

Z W Architects
Zakim Woo Architects
9018 Lindblade Street
Culver City, CA
Tel: 310.202.9900
Fax: 310.241.6228

OWNER
BARLOW RESPIRATORY HOSPITAL
2000 Stadium Way
Los Angeles, CA 90026
(213) 202-6845

ARCHITECT
Zakim Woo Architects
9018 Lindblade Street
Culver City, CA 90232
(310) 202-9900
(310) 841-6228 (fax)

STRUCTURAL ENGINEERS & MEP ENGINEERS
Walter P Moore
707 Wilshire Boulevard, Suite 2100
Los Angeles, CA 90017
(213) 694-4775
(925) 549-7313 (cel)



Agency Approval Stamp

REVIEWED IN ACCORDANCE WITH THE REGULATIONS OF THE BOARD OF ARCHITECTS AND ENGINEERS OF CALIFORNIA

APPROVED

Office of Sustainable Hospital Planning & Development
10/28/2024, 8:16:49 AM
SHP-15-15-00
Lynn Wang

FACILITY ID No.
11417

All plans, designs, arrangements and notes indicated or represented by this drawing are owned by and the property of Zakim Woo Architects and shall remain confidential and shall not be used or disclosed in any manner without the written permission of Zakim Woo Architects. Written dimensions on these drawings shall have precedence over verbal dimensions. Contractors shall verify and be responsible for all dimensions and conditions on the job, and this office shall be notified of any variations from the dimensions and conditions shown by these drawings.

NO.	ISSUE	DATE
1	BACKCHECK 1	10/21/24
2	OSHPD SUBMITTAL	08/03/24

Revisions

Name & Location:
BARLOW RESPIRATORY HOSPITAL
2000 STADIUM WAY
LOS ANGELES, CA 90026

Project Title:
MATERIAL TESTING & CONDITIONS ASSESSMENT PROGRAM (MTCAP) FOR DINING KITCHEN BUILDING AND ADDITIONS (1902 Bldg) BLD 00731

Key Plan:

Project No:
Issued For: MTCAP
Drawing:

SITE PLAN / LIFE AND FIRE SAFETY PLAN

Scale: AS NOTED ON DRAWINGS
Date: AUGUST 3, 2024
Drawing No:

A-1.00

